

Modular and expandable conveyor system

MATERIAL LOGISTICS

MSR (M-Station-Reel)



Storage



Description:

The M-Station-Reel is a modular roller conveyor system to buffer transport goods, especially component reels and JEDEC tray stacks. The M-Station-Reel is divided in independent segments, with a number of 1, 2 or 3 segments. The handover and takeover process can be done manually by an operator or via the HERMES interface. There are several applications available, like a usage as transfer or buffer system to connect inbound systems or storage systems, e.g. Dry Tower. The modular concept allows to extend the system, depending on the number of required positions.

Features:

- _ 1 / 2 / 3 segments
- _ transport height: 920 +/- 20mm
- _ payload: 3 kg/segment
- _ extendable concept
- _ controller

Options:

- _ transport height 1270mm
- _ manual insertion function
- _ NOK ejection sideways
- _ NOK ejection from front side
- _ cross slide 90°
- _ folding cover with interlock
- _ scanner bridge for label identification
- _ scanner bridge label/diameter/height
- _ cover hood screwed
- _ interlock chaining, shutdown N-1/ N+1
- _ extension modules
- _ signal lamp

M-Station-Reel | Technical Data

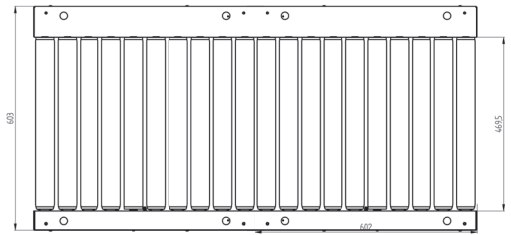
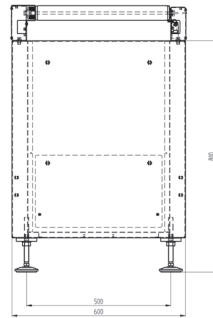
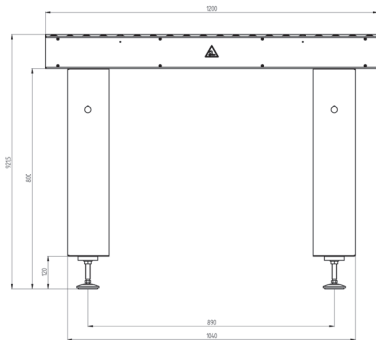

M-Station-Reel	MSR 01 600	MSR 02 1200	MSR 03 1800
Machine Configuration			
Number lanes	1	1	1
Number segments per lane	1	2	3
Transport height (mm)	920 +/- 50	920 +/- 50	920 +/- 50
Transport width max. (mm)	400	400	400
Interface	Hermes	Hermes	Hermes
Transport direction	yes	yes	yes
Operating side	from left to right	from left to right	from left to right
Fixes rail	front	front	front
Side rail	no	no	no
Transport speed (m/min)	20	20	20
Transport good format			
Transport good length (mm)	177 to 381	177 to 381	177 to 381
Transport good width (mm)	177 to 381	177 to 381	177 to 381
Transport good height (mm)	10 to 110	10 to 110	10 to 110
Payload per segment max. (kg)	3	3	3
Installation Requirements			
Power supply	230 V / 115 V (only with optional controller) 50 / 60 Hz +/- 10% (only with optional controller)	230 V / 115 V (only with optional controller) 50 / 60 Hz +/- 10% (only with optional controller)	230 V / 115 V (only with optional controller) 50 / 60 Hz +/- 10% (only with optional controller)
Power supply system	L1 + N + PE (only with optional controller)	L1 + N + PE (only with optional controller)	L1 + N + PE (only with optional controller)
Power consumption	0,13 kW (only with optional controller)	0,13 kW (only with optional controller)	0,13 kW (only with optional controller)
Machine Description			
Length (mm)	600	1200	1800
Width (mm)	603	603	603
Height (mm)	920	920	920
Netto weight (kg)	53	78	100
Noise level	57 dB	57 dB	57 dB

**ASYS
GROUP**

力丰电子|北京市西城区阜成门外大街2号万通新世界广场A1903室。

北京: 010 - 6857 8968

上海: 021 - 5046 1011

深圳: 0755 - 8832 1879

Subject to change without notice.

Some general descriptions and performance characteristics may not be applicable to all products. Technical specifications are subject to change without notice. Only features and technical data provided in purchasing contract are legally binding.

Printed in Germany